



SpeedFace-V5L Series

FingerPrint & Face & Palm & QR Code Verification Terminal
with Temperature and Mask Detection Technology



Fingerprint
Recognition



Face
Recognition



Palm
Recognition



QR Code



Temperature
Detection



Masked Face

Compatible with



SpeedFace-V5L



SpeedFace-V5L[TD]

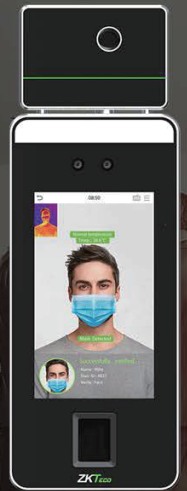

SpeedFace-V5L[TI]

SpeedFace-V5L Series using intelligent engineering facial recognition algorithms and the latest computer vision technology. It supports Fingerprint, facial and palm verification with large capacity and speedy recognition, also the facial camera support QR code with Mobile APP, as well as improves security performance in all aspects.

SpeedFace-V5L Series adopts touchless recognition technology and masked individual identification which eliminates hygiene concerns effectively. It is also equipped with ultimate antispoofing algorithm for facial recognition against almost all types of fake photos and videos attack. Importantly, the 3-in-1 palm recognition (Palm Shape, Palm Print and Palm Vein) is performed in 0.35 sec per hand; the palm data acquired will be compared with a maximum of 3,000 palm templates. Besides, its facial camera supports QR code, PDF417, Data Matrix, MicroPDF417, Aztec, and so on, with ZKBioAccess IVS Mobile APP support Dynamic QR code for T&A/A&C .

The TD/TI Version with mask detection help reduce the spread of germs and help prevent infections straightly at each access point of any premises and public areas such as hospitals, factories, schools, commercial buildings, stations during the recent global public health issue with its masked individual identification function during facial and palm verification.

SpeedFace-V5L Series support video intercom Both via mobile app ZSmart and via PC software ZKBioTalk, also they are integrated ONVIF Video protocol, so that they can connect to Onvif NVR to Video surveillance and recording.

SpeedFace-V5L support SIP Protocol connect to indoor unit.

Features

- Visible Light Facial Recognition
- Fingerprint and Palm Recognition
- QR code, PDF417, Data Matrix, MicroPDF417, Aztec
- Dynamic QR code with ZKBioAccess IVS Mobile APP
- Video intercom ZKBioTalk / APP: ZSmart
- Onvif Protocol, SIP Protocol (Only SpeedFace-V5L)
- Better hygiene with touchless biometric authentication and masked individual identification
- Anti-spoofing algorithm against print attack (laser, color and B/W photos), videos attack and 3D mask attack
- Available card modules: 125 kHz EM card / 13.56MHz IC card (MF)
- Supplement light with adjustable brightness

- Multiple Verification Methods: Fingerprint / Face / Palm / QR Code / Card / Password
 - Mask detection;facial verification available with masks(Only TD/TI)
 - Body temperature detection(Only TD/TI)
 - Temperature Measurement Distance: 30 ~ 50cm (1~ 1.64ft) (TD)
 - Temperature Measurement Distance: 30cm ~ 120cm (0.98ft~ 3.94ft) (TI)
 - Temperature Measurement Accuracy: $\pm 0.3^{\circ}\text{C}$ (TD)
 - Temperature Measurement Accuracy: $\pm 0.3^{\circ}\text{C}$ ($\pm 0.54^{\circ}\text{F}$), tested in a distance of 80cm (2.63ft) under 25°C (77°F) environment(TI)
 - Temperature Measurement Range: $34 \sim 45^{\circ}\text{C}$ ($93.2 \sim 113^{\circ}\text{F}$)(TD)
 - Temperature Measurement Range: $20^{\circ}\text{C} \sim 50^{\circ}\text{C}$ ($68^{\circ}\text{F} \sim 122^{\circ}\text{F}$)(TI)
- * Facial verification for masked individuals will increase FAR. Palm verification for masked individuals is recommended. Temperature measurement data is for reference only, not for medical use.
SpeedFace-V5L[TD]/[TI] is available for indoor enviroments without wind or direct sunlight.

Specifications

Product Model	SpeedFace-V5L	SpeedFace-V5L[TD]	SpeedFace-V5L[TI]
Display	5-inch Touch Screen	5-inch Touch Screen	5-inch Touch Screen
Fingerprint Capacity	6,000 (Optional: 10,000)	6,000 (Optional: 10,000)	6,000 (Optional: 10,000)
Face Capacity	6,000	6,000	6,000
Palm Capacity	3,000	3,000	3,000
Card Capacity	10,000 (Optional)	10,000 (Optional)	10,000 (Optional)
RFID	ID/IC (Optional)	ID/IC card (Optional)	ID/IC card (Optional)
QR Code	Dynamic / Static QR code (Optional)	Dynamic / Static QR code (Optional)	Dynamic / Static QR code (Optional)
Transactions	200,000	200,000	200,000
Operation System	Linux	Linux	Linux
Standard Functions	ADMS, T9 Input, DST, Camera, 9-digit User ID, Access Levels, Groups, Holidays, Anti-passback, Record Query, Tamper Switch Alarm, Multiple Verification Methods		
Hardware	1GHz Dual Core CPU, Memory 1G RAM / 8G Flash, 2MP WDR Low Light Camera, Adjustable Light Brightness LED		
Communication	TCP/IP, WiFi (Optional), Wiegand input / output, RS485		
Onvif Protocol	Standard	Standard	Standard
SIP Protocol	Optional	Not support	Not support
ZKBioTalk	Standard	Standard	Standard
ZSmart	Optional	Optional	Optional
Access Control Interface	3rd Party Electric Lock, Door Sensor, Exit Button, Alarm output, Auxiliary Input		
Facial Recognition Speed	$\leq 1\text{s}$	$\leq 1\text{s}$	$\leq 1\text{s}$
Biometrics Algorithms	ZKFinger V10.0 / ZKFace V5.8 & ZKPalm V12.0		
Power Supply	12V 3A	12V 3A	12V 3A
Operating Humidity	10% - 90%	10% - 90%	10% - 90%
Operating Temperature	$-10^{\circ}\text{C} \sim 45^{\circ}\text{C}$ ($14^{\circ}\text{F} \sim 113^{\circ}\text{F}$)	$16^{\circ}\text{C} \sim 32^{\circ}\text{C}$ ($60.8^{\circ}\text{F} \sim 89.6^{\circ}\text{F}$)	$16^{\circ}\text{C} \sim 35^{\circ}\text{C}$ ($60.8^{\circ}\text{F} \sim 95.0^{\circ}\text{F}$)
Dimensions (W*H*D)	91.93 * 202.93 * 21.5 (mm)	91.93 * 220 * 22.5 (mm)	92.0 * 262.0 * 23.5 (mm)
Supported Softwares/APP	ZKBio Access IVS / ZKBioTalk / ZSmart		

Configuration

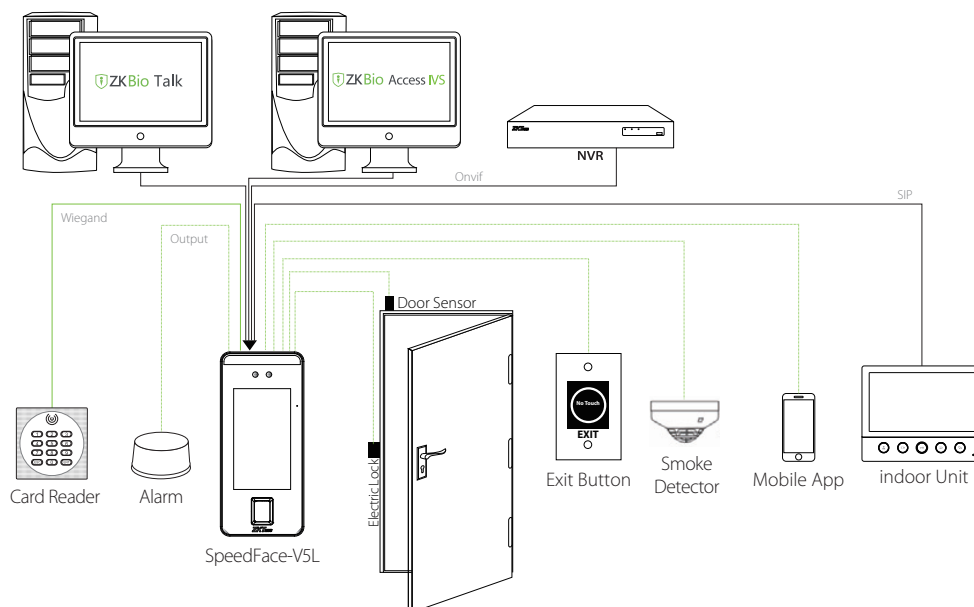

Dimensions (mm)

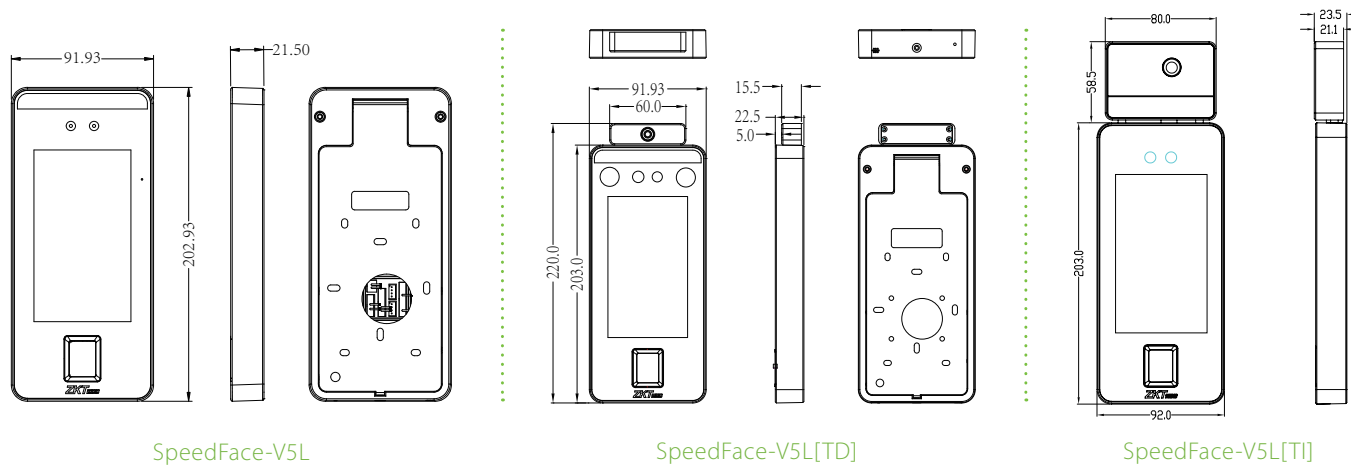

Supported NVR Models

Z8504NER, Z8508NER, Z8516NFR
POE Version: Z8504NER-4P, Z8508NER-8P, Z8516NFR-16P

SIP indoor Models: Vpad A2

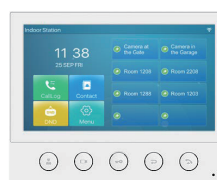

Mobile APP: ZSmart



V2.2 10/19/2022

